



## Base Line Installation Instructions

### CHARACTERISTICS

The integrated battery compartment in the bottom of the Base Line entry unit opens by moving a slider from left to right. Cable length is approximately 30 cm (11-3/4").

### DIMENSIONS/MOUNTING INSTRUCTIONS

The diameter of the cable hole should be a minimum 9 mm (3/8"), maximum 12 mm (7/16"). The hole must be deburred well to avoid damage to the cable.

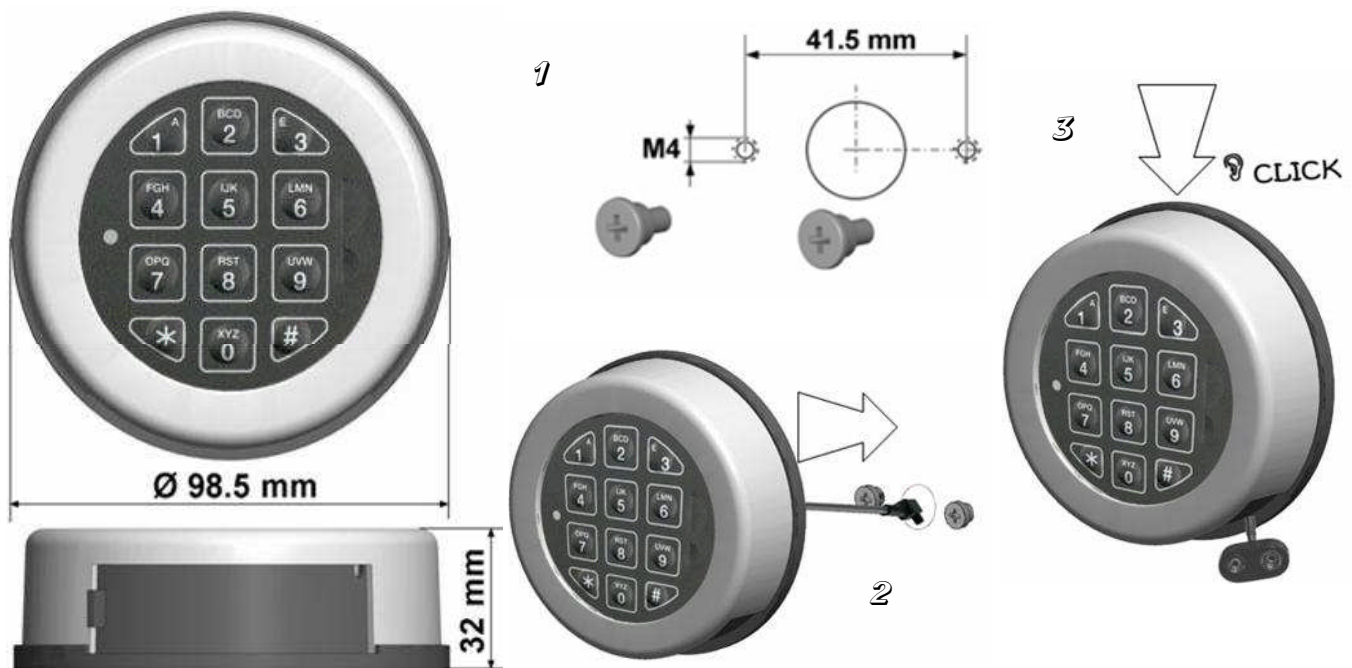

Affix the two (M4) shoulder screws. Route the cable through the cable hole and slide the unit on the shoulder screws. The back of the unit must touch the door surface. Control cable routing, then push the unit down until it snaps on positively.

### The Base Line entry unit should not be removed!

Connect one (1) battery to the battery clip. Only use 9V-ALKALINE batteries from brand name manufacturers like DURACELL™ or Eveready™. A series of signals indicates that the battery is weak and must be replaced.

Base Line inputs are available in various finishes; Textured Black, Matte Chrome (shown above), Bright Chrome and Bright Brass.