

Mechanical Lock Installation

Dear Valued Customers,

Since the mechanical lock was released more than a year ago, we now have gathered some experience about mistakes that occur while mounting the lock and the dial.

1. Shaft not inserted into the square cavity.

If the dial is not assembled correctly (see Technical Manual MD70•60 attached) the following can occur:

Instead of into the square cavity, the shaft is inserted crooked into the hexagonal cavity above. The result is that the numbers on the dial are shifted approximately 13 up or down. Additionally, the shaft has play and shifts approximately three numbers up when turned to the left and approximately 3 numbers down when turned to the right.

2. Lock does not open on "50".

We state in our instruction that the installer should try between 48 and 52. The lock itself is machine-set exactly to 50 and as long as the change key has not been used on the lock, the cam can always be turned to the two relevant positions for installation. These two positions can be found by lining up the markings on the cam and the lock cover:

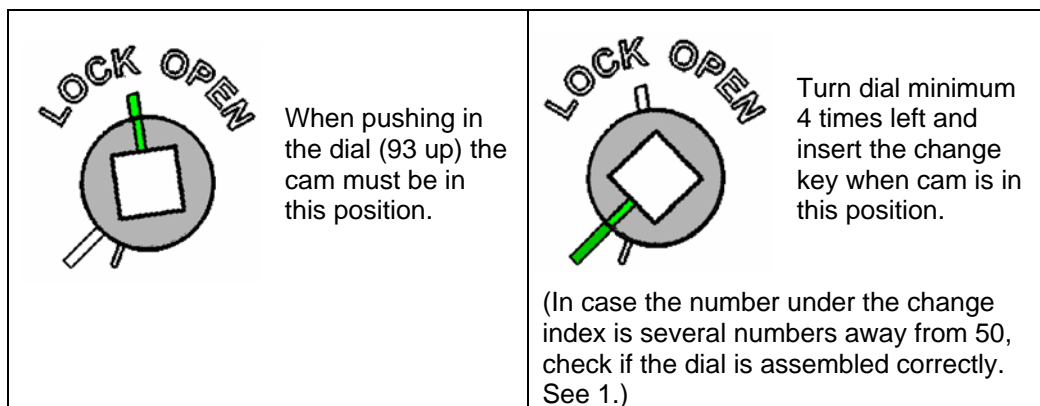

3. The cover should never be removed.

The relock can be damaged if the cover is not put on when the lock is in open position (bolt extended).

4. To replace a lock in the field

- Do not remove the cover
- Remove the mounting screws
- Pull the lock off the shaft
- Make sure the dial corresponds to 93 on the opening index on the dial ring.
- The star washer is on the dial shaft. Do not apply a second one!
- Slide the new lock (in open position) on the shaft and affix with mounting screws.

5. Mounting the lock to different mounting surfaces

In the installation instructions it is assumed that the lock is mounted to a solid flat mounting surface. In case there is an air gap underneath the lock body the star washer cannot be inserted into the lock and must instead be pushed on the shaft of the dial.



Please do not hesitate to contact us if you have any questions.

Kindest regards,

Your NL LOCK team.

No-Spy

MD60•60, MD70•60 Technical Manual



CHARACTERISTICS

This mechanical dial is delivered with a 6 mm square shaft and can be used only with lock ML67•40. The numbers on the No-Spy dial can only be read up close by the operator. The code numbers cannot be “spied on” from a distance. The dial is available in black (MD60•60) and mat chrome plated (MD70•60). The provided shaft can be used for door diameters up to 125 mm / 5 inch.

DIMENSIONS / MOUNTING INSTRUCTION

Measure the distance (**D**) between the mounting surfaces of the dial and the lock (see picture below). Cut the shaft in one of the eight provided grooves. Use the table below to determine in which groove to cut. Do not leave more segments on the shaft than necessary. Normally no deburring is required.

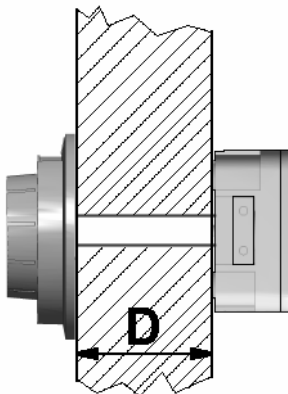

Distance (D) less than		Cut Groove #
23 mm	0.9 inch	1
36 mm	1.4 inch	2
48 mm	1.9 inch	3
61 mm	2.4 inch	4
74 mm	2.9 inch	5
87 mm	3.4 inch	6
100 mm	3.9 inch	7
112 mm	4.4 inch	8

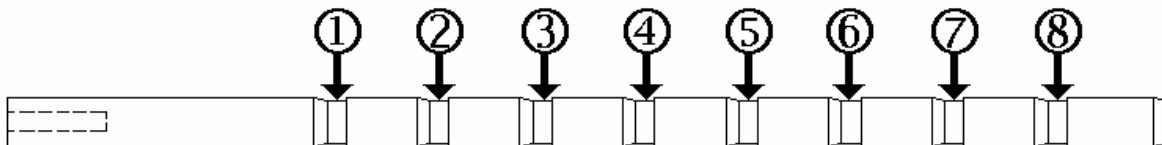

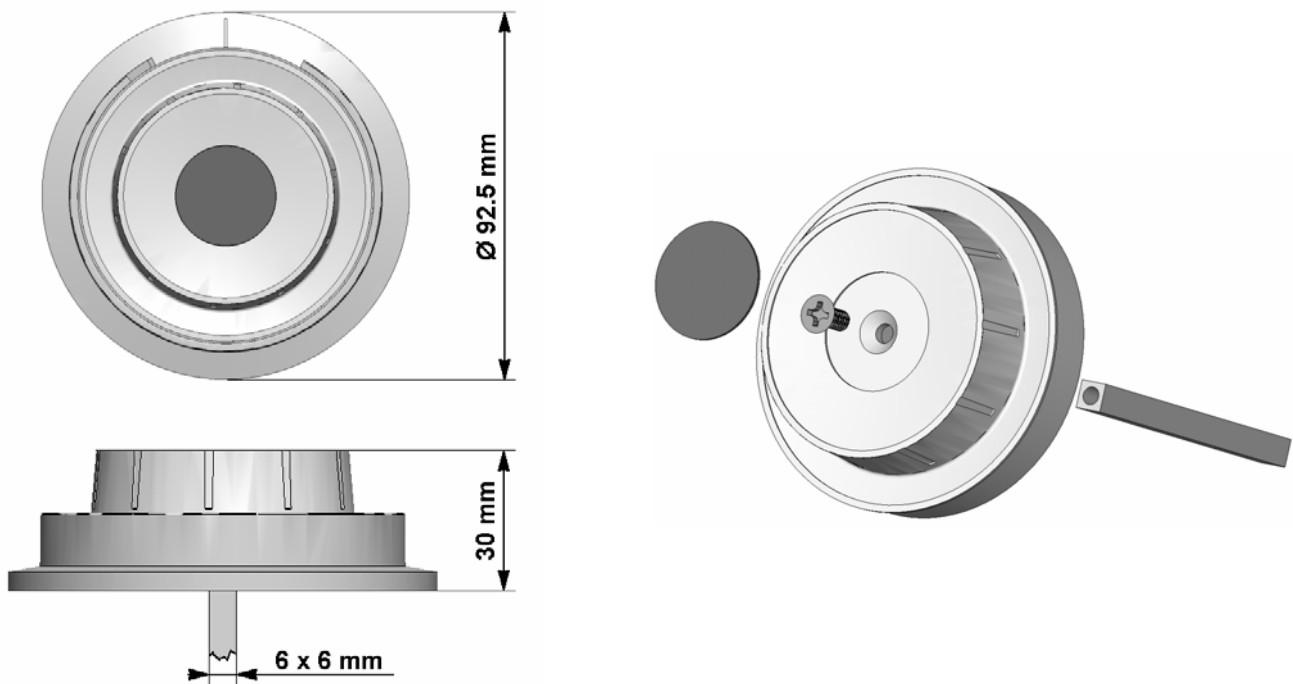

Affix the shaft in the square hole with the provided screw in the dial. Make sure the shaft is seated all the way in the square hole and does not rest in the hexagonal cavity above. Cover the screw with the larger label. The small label is not used in this assembly.

Install the lock first according to the installation instruction.

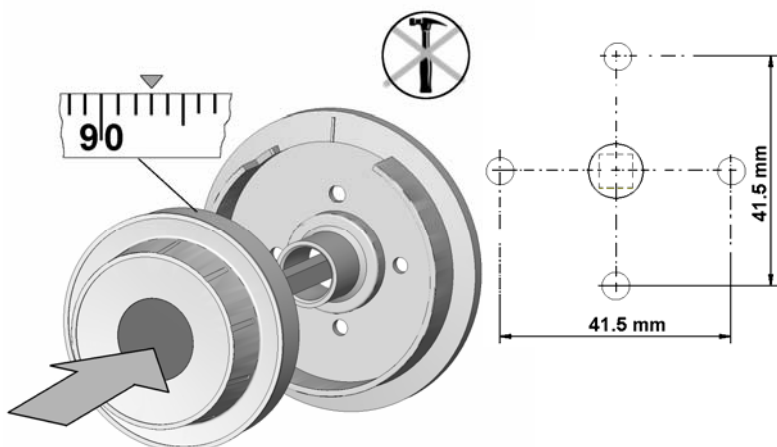

The diameter of the spindle hole should be maximum 12 mm. Mount the dial plate with two M4 or 8-32" screws (not included) so that the opening index is at 12:00 position.

With the lock in OPEN position (bolt retracted) hold the dial in a way that approximately "93" is lined up with the opening index and push it with some pressure into the lock. The shaft cannot be pulled out.